

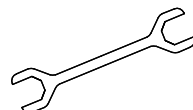

PREDL GU300 INSIDE DROP INSTALLATION AND PARTS GUIDE

1. TOOLS REQUIRED:

1 - 9/16 " OPEN END WRENCH



2 - 9/16 " SOCKET AND SOCKET WRENCH

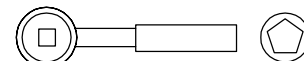

3 - EPOXY

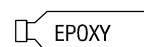

4 - CUT OFF SAW IF REQUIRED

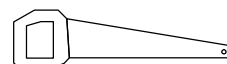

5 - DRILL

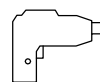

6 - 3/8" DRILL BIT

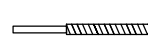

2. LIST OF PARTS SUPPLIED

- 1 - GU300 INSIDE DROP HOUSING
- 1 - GU300 INSPECTION CAP
- 1 - GU300 INSIDE DROP GASKET
- 1 - GU300 CAP DROP CABLE
- 4 - SIMPSON STAINLESS STEEL WEDGE ANCHORS

3. DIAGRAM OF PARTS SUPPLIED

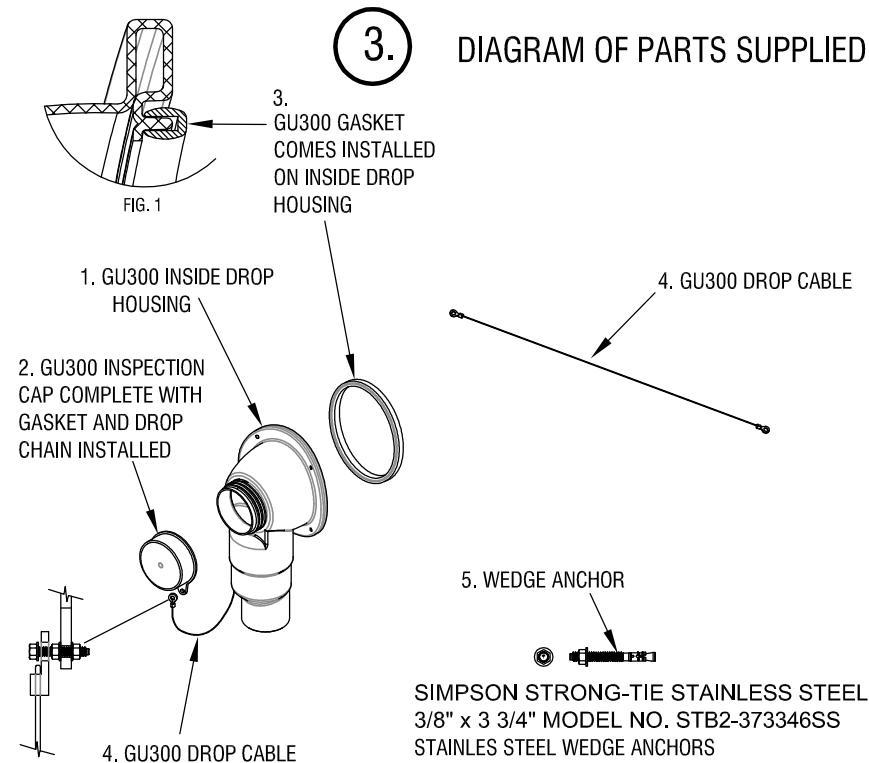

1. WHEN INLET IS PRE CAST WITH BELL IN PLACE:

STEP ONE INSTALLING WEDGE ANCHORS :

TO MARK THE DRILL LOCATIONS OF THE FOUR STAINLESS STEEL WEDGE ANCHORS LOOK INTO THE INSPECTION CAP OPENING HOLD THE INSIDE DROP HOUSING VERTICALLY AGAINST THE INSIDE OF THE MANHOLE WALL OVER THE CENTER OF THE PRE CAST BELL AND MARK THE FOUR 3/8" DIA. DRILL HOLE LOCATIONS. PUT THE INSIDE DROP DOWN AND NOW AT EACH OF THESE FOUR POINTS DRILL A 3/8" DIA. HOLE 3" DEEP. COAT THE INSIDE OF THE DRILL HOLES AND THE WEDGE ANCHORS WITH EPOXY AND INSERT WEDGE ANCHORS. ALLOW EPOXY TO DRY AS PER MANUFACTURERS SPECIFICATIONS.

INSTALL THE PREDL GASKET TO THE GU300 INSIDE DROP AS SHOWN IN FIG. 1.

STEP TWO

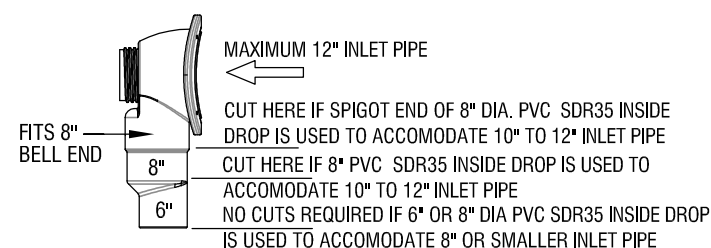

FIG. 2

PLACE GU300 INSIDE DROP AND GASKET IN POSSITION OVER 3/8" DIA. WEDGE ANCHORS CENTERED WITH INLET OPENING AND ATTACH USING 3/8" NUT AND WASHER AS SHOWN IN FIG. 2

STEP THREE

CUTTING INSTRUCTIONS:



STEP FOUR

ADDING INSIDE DROP DOWN PIPE :

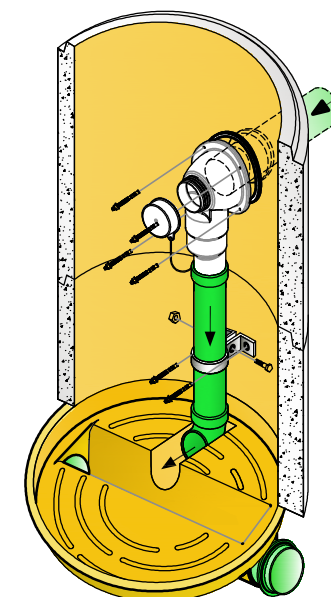
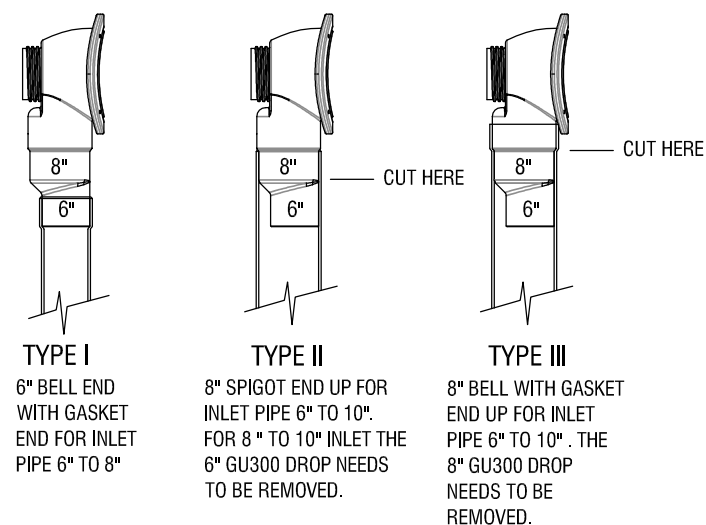

FULLY ASSEMBLED DETAIL

N.T.S.

SPECIFIED PARTS POSSIBLY REQUIRED BUT NOT SUPPLIED

1. WHEN INLET NEEDS TO BE CORED:

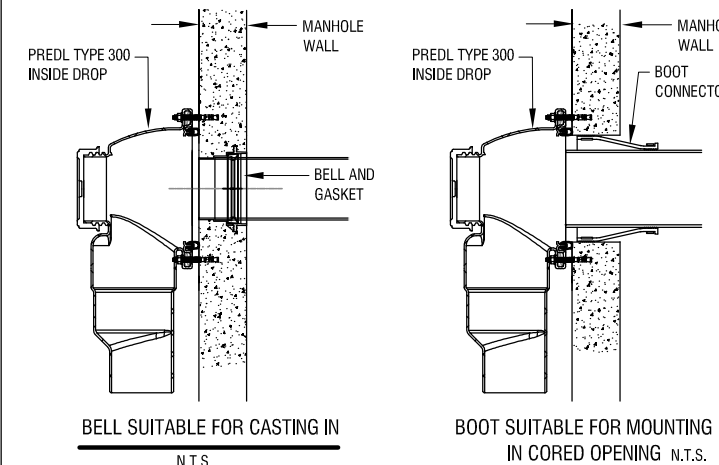
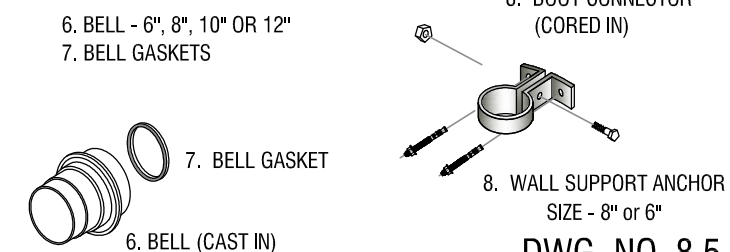
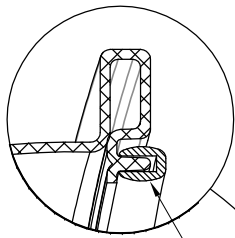
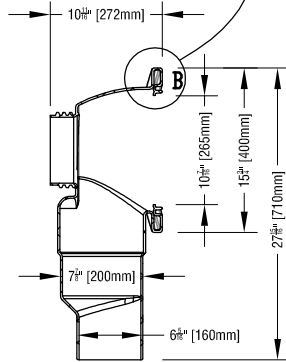

DIAGRAM OF PARTS POSSIBLY REQUIRED FOR INSIDE DROP BUT NOT SUPPLIED





DETAIL B
N.T.S.



SECTION A-A N.T.S.

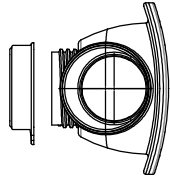

VIEW C-C N.T.S.

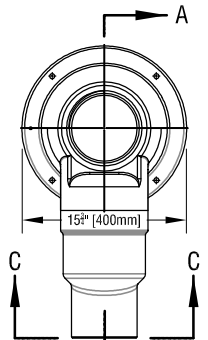

PROFILE VIEW N.T.S.

INSIDE DROP TYPE 300

SDR 26 PVC PIPE DIMENSION SPECIFICATIONS

SIZE		O.D.		I.D.		WALL THICKNESS		DROP TYPE
INCH	mm	INCH	mm	INCH	mm	INCH	mm	
6"	152.40	6.275	159.38	5.793	147.142	0.241	6.121	300
8"	203.20	8.400	213.36	7.754	196.952	0.323	8.204	300
10"	254.00	10.500	266.70	9.692	246.177	0.404	10.262	300
* 12"	304.80	12.500	317.50	11.538	293.065	0.481	12.217	*300

* Note: Cast in Bell only

SDR 35 PVC PIPE DIMENSION SPECIFICATIONS

SIZE		O.D.		I.D.		WALL THICKNESS		
INCH	mm	INCH	mm	INCH	mm	INCH	mm	
4"	101.60	4.215	107.06	3.975	100.965	0.120	3.048	300
6"	152.40	6.275	159.38	5.915	150.241	0.180	4.572	300
8"	203.20	8.400	213.36	7.920	201.128	0.240	6.096	300
10"	254.00	10.500	266.70	9.900	251.460	0.300	7.620	300
* 12"	304.80	12.500	317.50	11.780	299.212	0.360	9.144	*300

* Note: Cast in Bell only

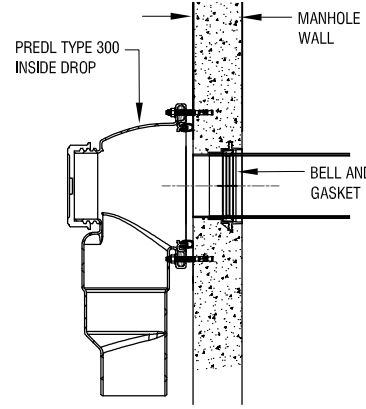

BELL SUITABLE FOR CASTING IN
N.T.S.

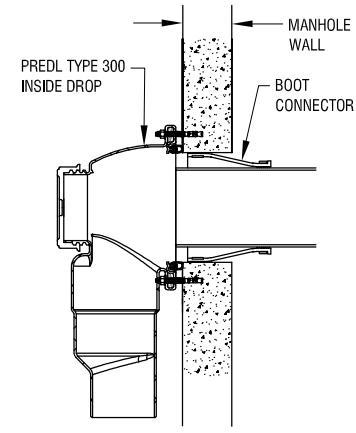

BOOT SUITABLE FOR MOUNTING IN CORED OPENING N.T.S.

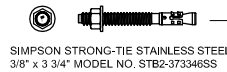

SIMPSON STRONG-TIE STAINLESS STEEL
3/8" x 3 3/4" MODEL NO. STB2-373346SS

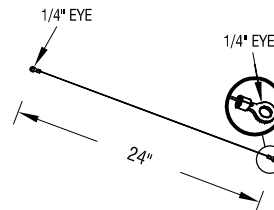

DROP CABLE N.T.S.
(SEE DWG. 8.3 FOR DETAILS)

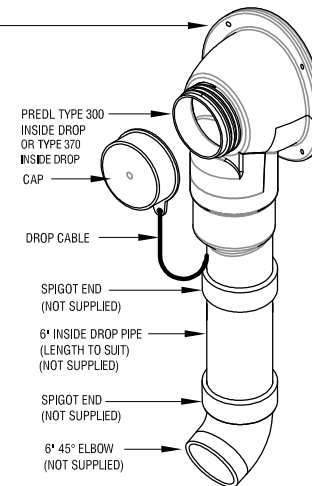

TYPICAL INSIDE DROP ASSEMBLY



7520 Conrad Street
Burnaby, B.C. V5A 2H7

Phone : 604 415-9944
Fax : 604 415-9954

DRAWN BY : R.H. DATE DRAWN : OCT. 31/13

APPROVED :

REVISION : NO. DATE:

SCALE :

LOAD RATING

MATERIAL SPECIFICATION:

HDPE

SPECIFIED FOR:

DESCRIPTION:

INSIDE DROP ASSEMBLY
TYPE 300 FOR 1200mm
FULLY LINED PRECAST
MANHOLE

DWG. NO. 8.2.1 REV. NO. *

WORK ORDER NUMBER:

INSIDE DROP ASSEMBLY TYPE 300- FOR 1200mm FULLY LINED PRECAST MANHOLE



7520 Conrad Street
Burnaby, B.C. V5A 2H7

Phone : 604 415-9944
Fax : 604 415-9954

DRAWN BY : R.H.	DATE DRAWN : NOV. 01/13
--------------------	----------------------------

APPROVED :

REVISION : NO:	DATE:
-------------------	-------

SCALE :

LOAD RATING

MATERIAL SPECIFICATION:

SEE DWG. NO. 19

SPECIFIED FOR:

DESCRIPTION:

PREDL SYSTEMS FULLY LINED
MANHOLE BASE WITH CONCENTRIC
STYLE LID, INSIDE DROP, NON SKID
BASELINER AND EXTENDED BASE

DWG. NO. 3.1.1	REV. NO. *
--------------------------	----------------------

WORK ORDER NUMBER:

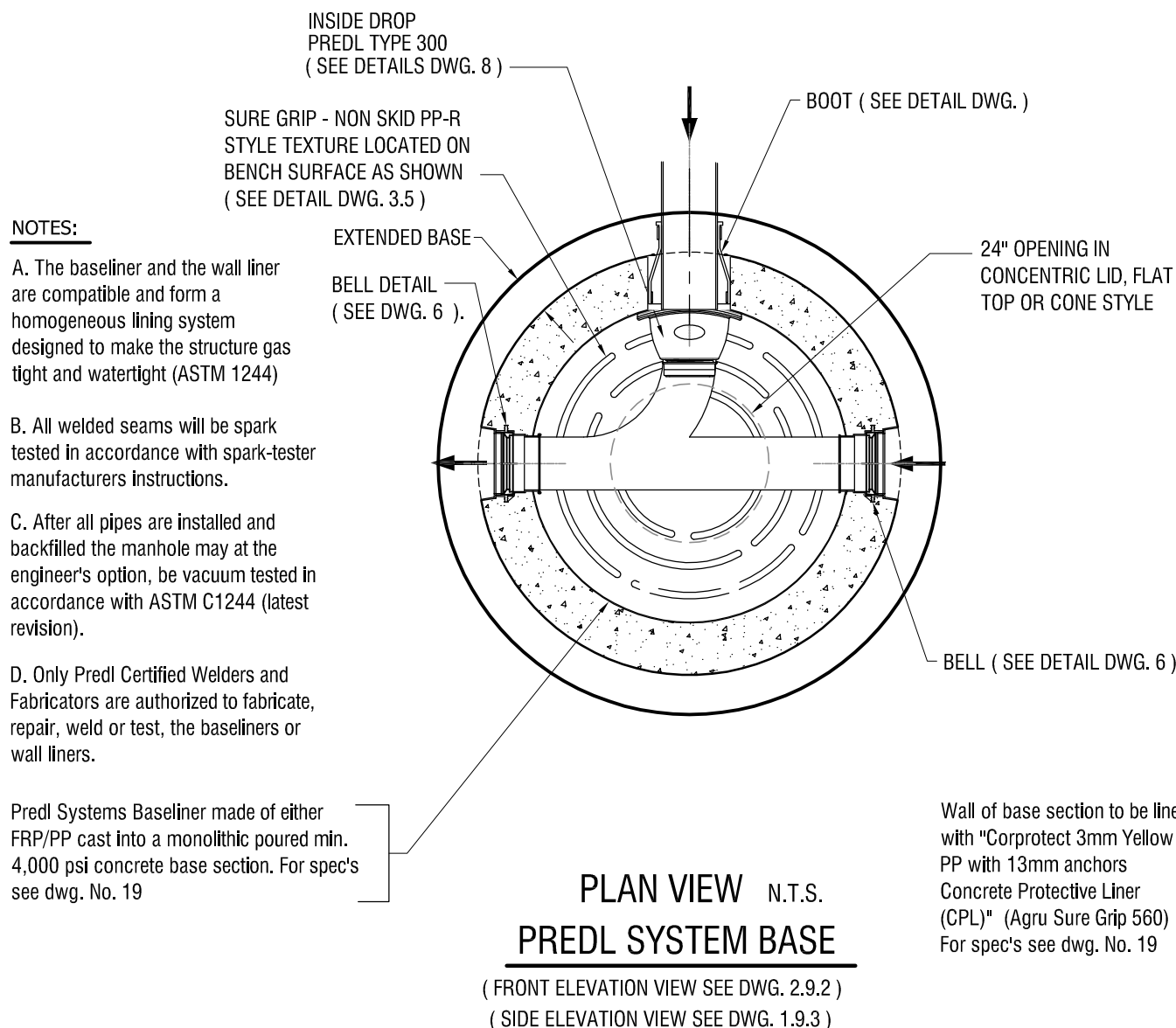

PREDL SYSTEMS FULLY LINED MANHOLE BASE WITH CONCENTRIC STYLE LID, INSIDE DROP, NON SKID BASELINER AND EXTENDED BASE

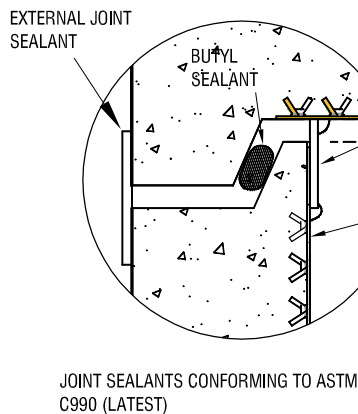

(SEE DETAIL DWG. 4.3)
3 to 4" WIDE PP CAP STRIP EXTRUSION
WELDED TOP AND BOTTOM (SEE DETAIL DWG. 4.3)

PREDL SYSTEMS
POLYPROPYLENE
CORPROTECT CPL

MANHOLE RING AND COVER

TELESCOPIC LID OPENING - WATERTIGHT
AND ADJUSTABLE (SEE DETAIL DWG. 5)

TELESCOPIC
LID LINER

LID
ECCENTRIC
FLAT TOP
W/ PREDL
CPL

RISER SECTIONS
W/ PREDL PP CORPROTECT CPL

Wall of riser sections to be
lined with "Corprotect 3mm
Yellow PP with 13mm anchors
Concrete Protective Liner
(CPL)" (Agu Sure Grip 560)
For spec's see dwg. No. 19

3 to 4" WIDE PP CAP STRIP
EXTRUSION WELDED TOP AND
BOTTOM
(SEE DETAIL DWG. 4.3)

48

INSIDE DROP
(SEE DETAIL DWG. 8)

ANCHOR

BASE
C/W PREDL SYSTEM
BASELINER

6

8

FRONT ELEVATION VIEW N.T.S.

(SIDE ELEVATION VIEW SEE DWG. 1.9.3)
(PLAN VIEW SEE DWG. 3.1.1)

NOTES:

A. The baseliner and the wall liner are compatible and form a homogeneous lining system designed to make the structure gas tight and watertight (ASTM 1244)

B. All welded seams will be spark tested in accordance with spark-tester manufacturers instructions.

C. After all pipes are installed and backfilled the manhole may at the engineer's option, be vacuum tested in accordance with ASTM C1244 (latest revision).

D. Only Predl Certified Welders and Fabricators are authorized to fabricate, repair, weld or test, the baseliners or wall liners.

Predl Systems Baseliner made of either FRP/PP cast into a monolithic poured min. 4,000 psi concrete base section.
For spec's see dwg. No. 19



7520 Conrad Street
Burnaby, B.C. V5A 2H7

Phone : 604 415-9944
Fax : 604 415-9954

DRAWN BY : R.H. DATE DRAWN : OCT. 31/13

APPROVED :

REVISION : NO: DATE:

SCALE : N.T.S.

LOAD RATING

MATERIAL SPECIFICATION:

SEE DWG. NO. 19

SPECIFIED FOR:

DESCRIPTION:

PREDL SYSTEMS FULLY LINED
MANHOLE WITH ECCENTRIC FLAT
TOP STYLE LID &/TELESCOPIC LID
LINER, NO TURNBACK JOINTS, CAP
STRIPS, ONE BUTYL SEALANT
STRIP, INSIDE DROP AND
EXTENDED BASE

DWG. NO. 2.9.2 REV. NO. *

WORK ORDER NUMBER:

PREDL SYSTEMS FULLY LINED MANHOLE WITH ECCENTRIC FLAT TOP STYLE LID &/TELESCOPIC LID LINER, NO TURNBACK JOINTS, CAP STRIPS, ONE BUTYL SEALANT STRIP, INSIDE DROP AND EXTENDED BASE

EXTERNAL JOINT SEALANT

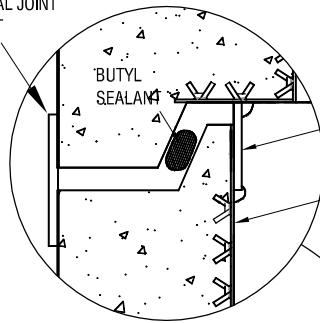

JOINT SEALANTS CONFORMING TO ASTM C990 (LATEST)

3 to 4" WIDE PP CAP STRIP EXTRUSION WELDED TOP AND BOTTOM

PREDL SYSTEMS POLYPROPYLENE CORPROTECT CPL

MANHOLE RING AND COVER

TELESCOPIC LID LINER - WATERTIGHT AND ADJUSTABLE (SEE DETAIL DWG. 5.8)

CORRESPONDING DRAWINGS:

2.92 - FRONT ELEVATION VIEW
3.1 - PLAN VIEW
5D - LID AND TELESCOPIC LINER
8 - INSIDE DROP DETAIL

LID ECCENTRIC FLAT TOP W/ PREDL CPL
RISER SECTIONS W/ PREDL PP CORPROTECT CPL

BOOT HUB (SEE DETAIL DWG.)

3 to 4" WIDE PP CAP STRIP EXTRUSION WELDED TOP AND BOTTOM

INSPECTION CAP

48
INSIDE DROP (SEE DETAIL DWG. 8)

ANCHOR

Wall of riser sections to be lined with "Corprotect 3mm Yellow PP with 13mm anchors Concrete Protective Liner (CPL)" (Agru Sure Grip 560) For spec's see dwg. No. 19

BASE C/W PREDL SYSTEM BASELINER

SIDE ELEVATION VIEW

N.T.S.

(FRONT ELEVATION VIEW SEE DWG. 2.9.2)
(PLAN VIEW SEE DWG. 3.1)

NOTES:

- The baseliner and the wall liner are compatible and form a homogeneous lining system designed to make the structure gas tight and watertight (ASTM 1244)
- All welded seams will be spark tested in accordance with spark-tester manufacturers instructions.
- After all pipes are installed and backfilled the manhole may at the engineer's option, be vacuum tested in accordance with ASTM C1244 (latest revision).
- Only Predl Certified Welders and Fabricators are authorized to fabricate, repair, weld or test, the baseliners or wall liners.

Predl Systems Baseliner made of either FRP/PP cast into a monolithic poured min. 4,000 psi concrete base section. For spec's see dwg. No. 19



7520 Conrad Street
Burnaby, B.C. V5A 2H7

Phone : 604 415-9944
Fax : 604 415-9954

DRAWN BY : R.H. DATE DRAWN : OCT. 31/13

APPROVED :

REVISION : NO. DATE:

SCALE : N.T.S.

LOAD RATING

MATERIAL SPECIFICATION:

SEE DWG. NO. 19

SPECIFIED FOR:

DESCRIPTION:
PREDL SYSTEMS FULLY LINED MANHOLE WITH ECCENTRIC FLAT TOP STYLE LID &/TELESCOPIC LID LINER, NO TURNBACK JOINTS, W/CAP STRIPS, ONE BUTYL SEALANT STRIP, INSIDE DROP AND EXTENDED BASE

DWG. NO. 1.9.3 REV. NO. *

WORK ORDER NUMBER:

PREDL SYSTEMS FULLY LINED MANHOLE WITH ECCENTRIC FLAT TOP STYLE LID &/TELESCOPIC LID LINER, NO TURNBACK JOINTS, W/CAP STRIPS, ONE BUTYL SEALANT STRIP, INSIDE DROP AND EXTENDED BASE