

**Inlet Baffle**  
Ø4" PVC Tee Assembly

Per NH DES ENV-WQ 1010.07,  
Shall Penetrate at Least 8" Below Liquid  
Level, But in No Case Greater Than the  
Depth of the Outlet Baffle

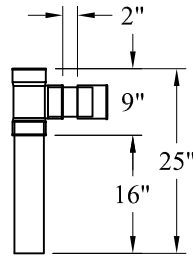

**Intermediate Baffle**  
(Where Required)  
Ø4" PVC Tee  
Assembly

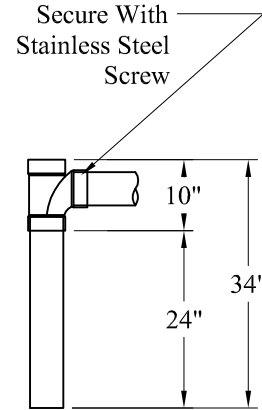

**Outlet Baffle**  
Ø4" PVC Tee Assembly

Per NH DES ENV-WQ 1010.07,  
Shall Extend to a Distance Below the  
Surface of the Liquid Level Equal to 40%  
of the Liquid Depth.

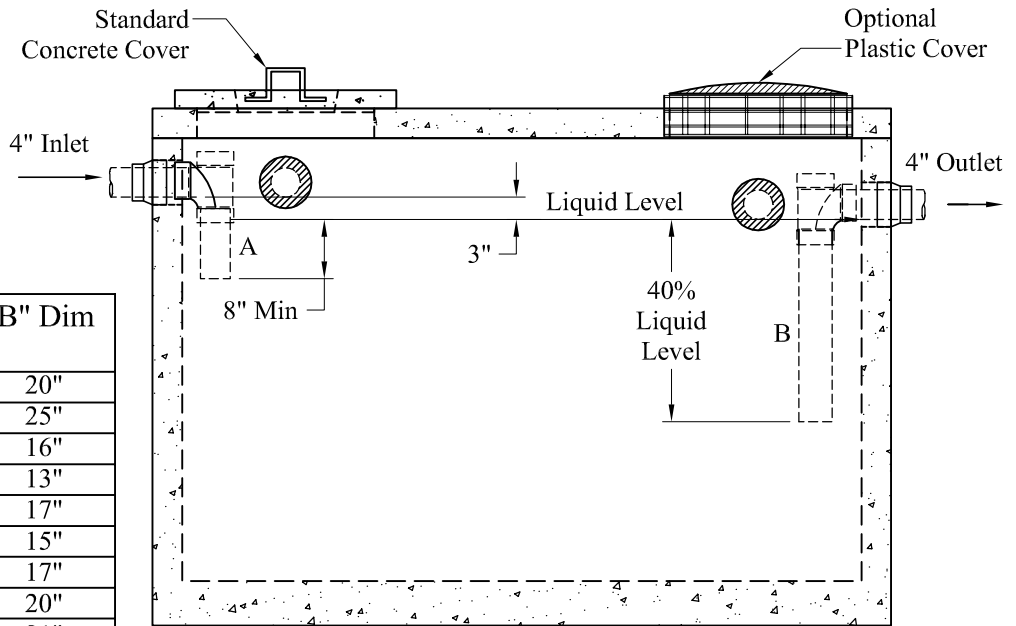

Light Duty Tanks	"B" Dim
1,000 Gals	20"
1,250 Gals	25"
1,250 Gals (Short)	16"
1,250 Gals (Ledge)	13"
1,500 Gals	17"
1,500 Gals (Ledge)	15"
1,750 Gals	17"
2,000 Gals	20"
2,500 Gals	21"

**General Notes**

- Internal PVC Baffles Available (Sch 40 PVC Pipe Typ)  
**Inlet:** Shall Penetrate at Least 8" Below the Liquid Level,  
 But Not Deeper Than the Outlet Baffle.  
**Outlet:** Shall Extend Below the Surface of the Liquid Equal  
 to 40% of the Liquid Depth.

Phoenix  
Precast  
Products

Typical Tank Baffle  
Assembly Options  
Light Duty Tanks