

General Notes

1. Concrete: $f_c = 4,000$ psi @ 28 Days Minimum
2. Reinforcement Steel Conforms to:
ASTM A615 Grade 60 Black Deformed Bars
3. Est Weight: 255 Lbs / Enclosure

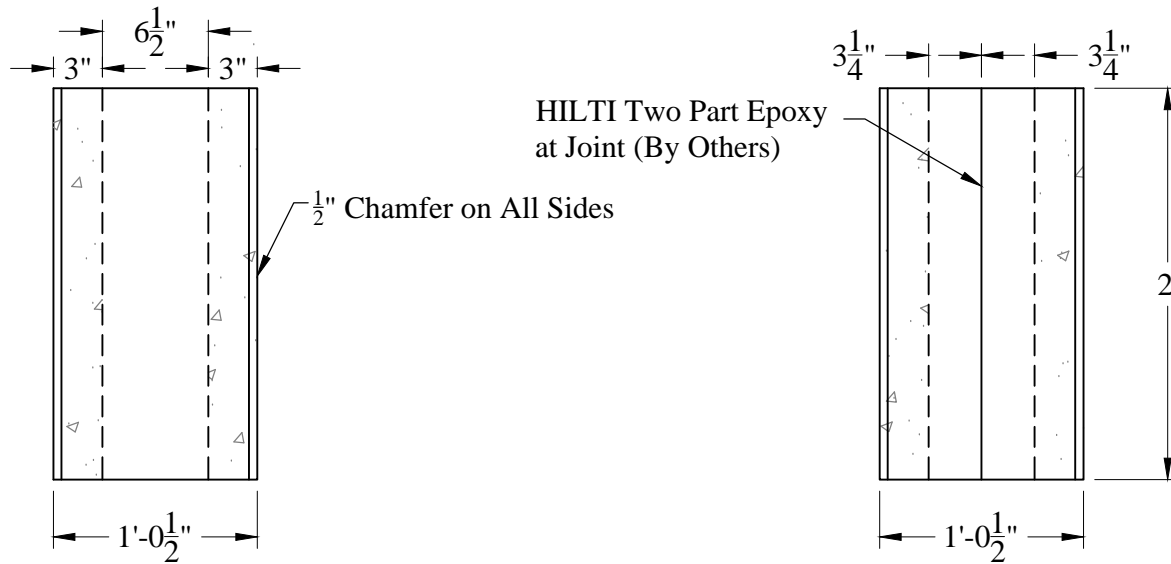
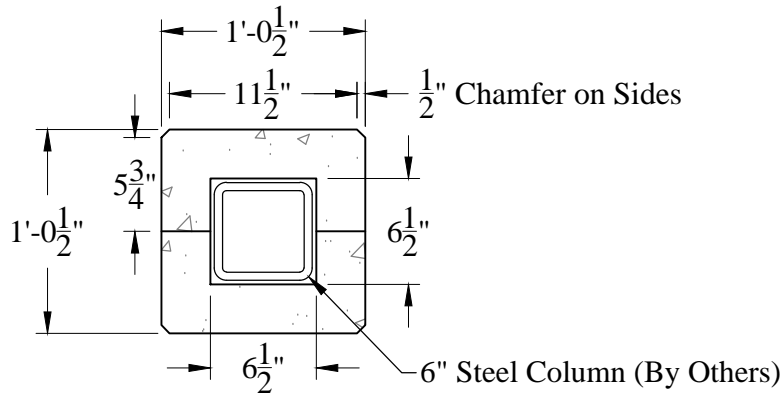

CP-2

Phoenix
Precast
Products

1'-0 $\frac{1}{2}$ " x 1'-0 $\frac{1}{2}$ " x 2'
Steel Column
Enclosure