

1-800-639-2199

Fax (603) 224-2927

Marine\MooringWeights\3000 Lb Mooring Weight_(v)

Phoenix Precast Products

Phoenix Precast Products

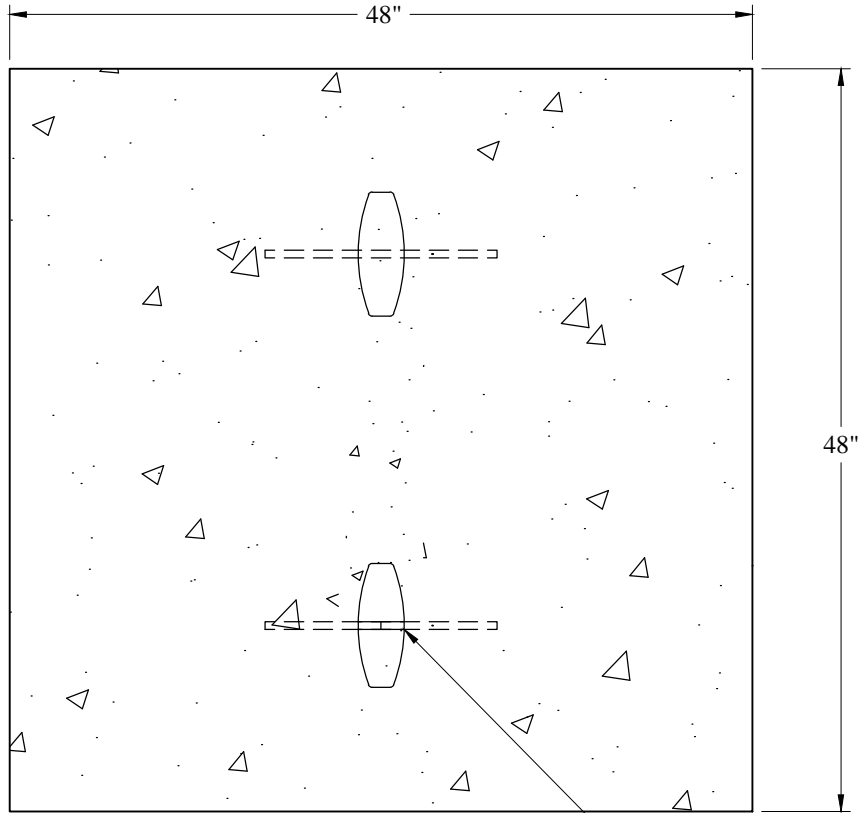

Recessed Opening Must Accept 1/2" Shackle

Recessed Stainless Steel Lifting Handle

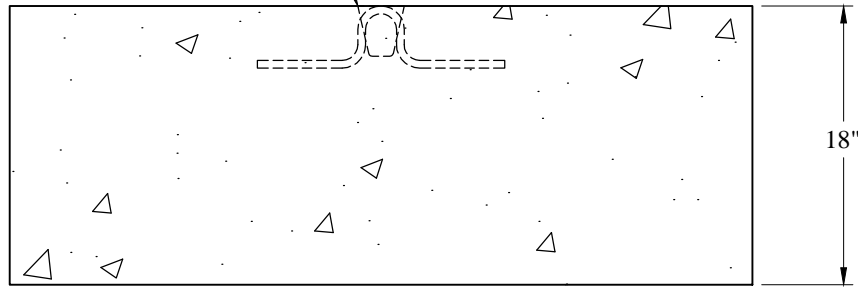

General Notes

1. Concrete: $f_c = 4,000$ psi @ 28 Days Minimum
2. Fiber Reinforcement
3. Steel Reinforcement: ASTM A615 Grade 60
4. 304 Stainless Steel Lifting Handle
5. Est Weight: 3,000 Lbs

Phoenix
Precast
Products

3,000 Lb
Mooring Weight

P/N: MW3000