

# THE PRESBY MAZE™

## INSTALLATION INSTRUCTIONS

A Presby Maze™ typically weighs 100-200 lbs. Installation is simple and should take only a few minutes:

**Step 1:** Unfold the Presby Maze™ into a rectangle.

TOP VIEW OF PROPERLY UNFOLDED PRESBY MAZE

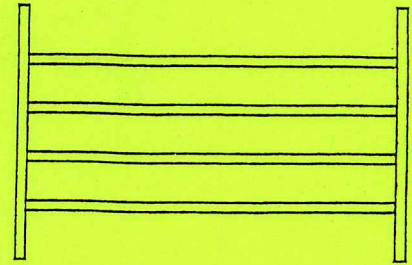

**Step 2:** Install the Presby Maze™ in the center of the bottom section of the septic tank. The Presby Maze™ must be orientated so it's legs rest on the bottom of the tank and the inlet and outlet end walls correspond with the inlet and outlet of the tank. The Presby Maze™ is clearly labeled inlet, outlet, and top. In addition the inlet and outlet end walls are distinctive should there be any confusion. The Presby Maze™ end walls are constructed of flexible sheet plastic which typically extends about 6" beyond the end wall's PVC pipe frame. The sheet plastic is designed to mould to the interior contours of the septic tank. Do not cut the plastic or alter the Presby Maze™ in any way.

PRESBY MAZE INSTALLED IN BOTTOM SECTION OF SEPTIC TANK

TOP VIEW

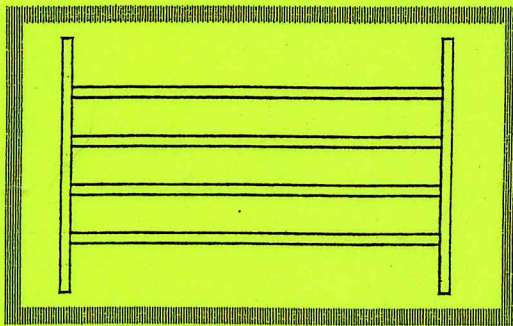

SIDE VIEW

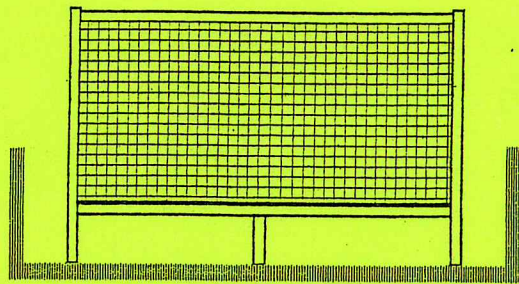

OUTLET NOTCH

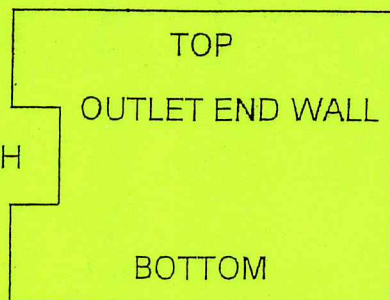

INLET END WALL

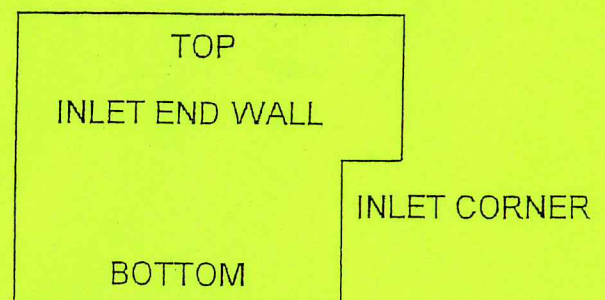

**Step 3:** Carefully lower the top section of the septic tank over the Presby Maze™. Be careful not to crush the Presby Maze™ and use extra care if the tank has concrete baffles.

If we can assist you in any way please contact us

To Learn More  
About Septic Systems  
Visit Our Web Site

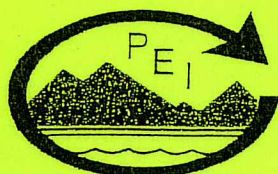

**PRESBY ENVIRONMENTAL, INC.**  
Protecting You and the Environment

143 Airport Rd., Whitefield, NH 03598

Tel: 1-800-473-5298

Fax: 1-603-837-9864

[www.presbvenvironmental.com](http://www.presbvenvironmental.com)

E-mail: [info@presbyeco.com](mailto:info@presbyeco.com)