

Recessed Handles 4X

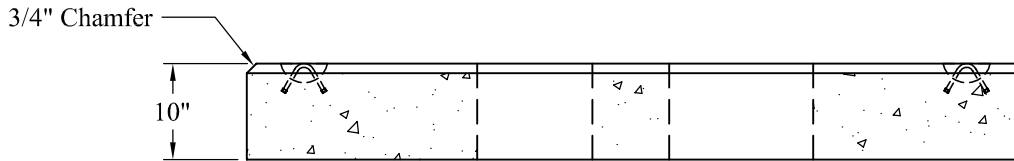

General Notes

1. Concrete: $f_c = 5,000$ psi @ 28 Days Minimum. 6% (+/- 1%) Air Entrainment.
2. Reinforcing Steel: Conforms to Latest ASTM-A615 Grade 60 Black Deformed Bars.
3. Conforms to ACI 318

Est Weight: 4,450 Lbs

Phoenix
Precast
Products

Liberty Utilities
LU-MS 2582 (NG 44-113)
3 Phase Transformer Pad
75-500 KVA