

Plan View

1. Concrete: $f_c = 5,000$ psi @ 28 Days Minimum
2. Reinforcing Steel: ASTM-A615 Grade #60
3. Anchor Bolts As Specified by Contractor
4. Size, Location, and Material of Conduits As Specified by Contractor
5. $\varnothing \frac{3}{4}$ " x 8' Grounding Rod by Others

Est Weight: 3,900 Lbs

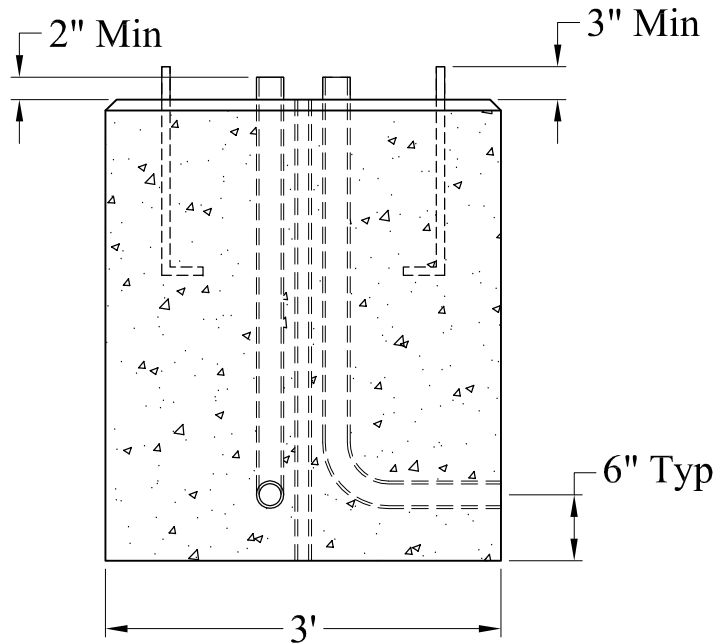

Side View

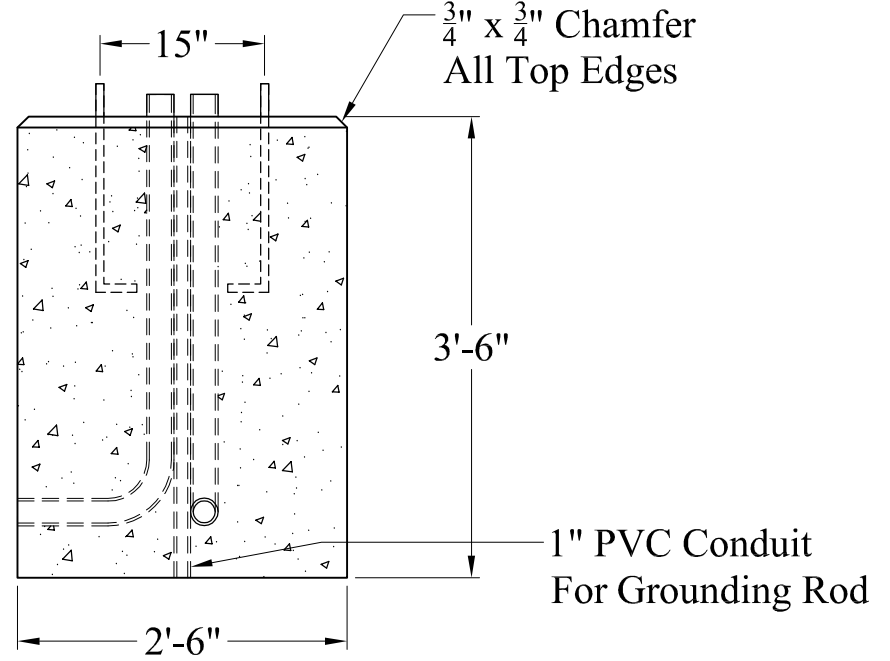

Front View

Phoenix Precast Products

Phoenix Precast Products

Customer: NH DOT	Job No.	Date 12/15/11	Drawn By: EWS	Phoenix Precast Products	3' x 2'-6" x 3'-6" NH DOT Controller Cabinet Foundation
Location:	Custom No. C-2934	Rev: 0	App'd:		