

**Knockouts For Bed Installation**

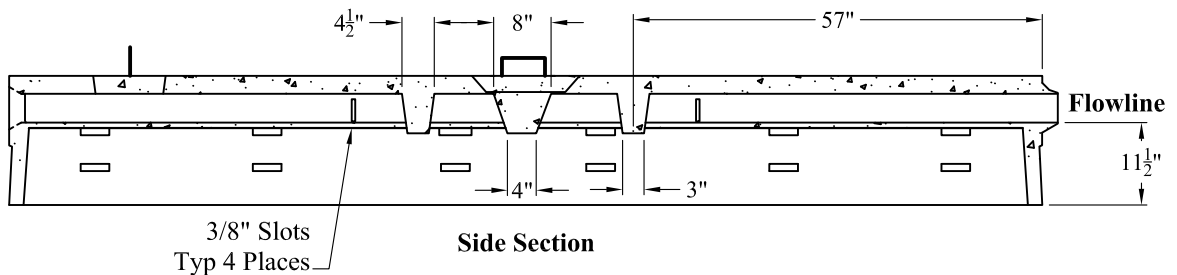

**General Notes**

1. Steel Reinforcement Conforms to Latest ASTM Specifications: ASTM-A615 Grade 60 Rebar
2. Concrete:  $f_c = 4,000$  psi @ 28 Days Minimum
3. Design Loading: AASHTO- HS20-44
4. Distribution Line Running Length of Chamber
5. Est Weight: 3,200 Lbs

**Phoenix  
Precast  
Products**

**4Ft x 12Ft x 18In  
"L" Flow Diffuser  
Leaching Chamber**

**P/N: LC-4X12X18LHD**