

Dim "H"	P/N:	Est Weight:
12"	DIR-30X12	1,000 Lbs
18"	DIR-30X18	1,500 Lbs
24"	DIR-30X24	2,000 Lbs
30"	DIR-30X30	2,500 Lbs
36"	DIR-30X36	3,000 Lbs

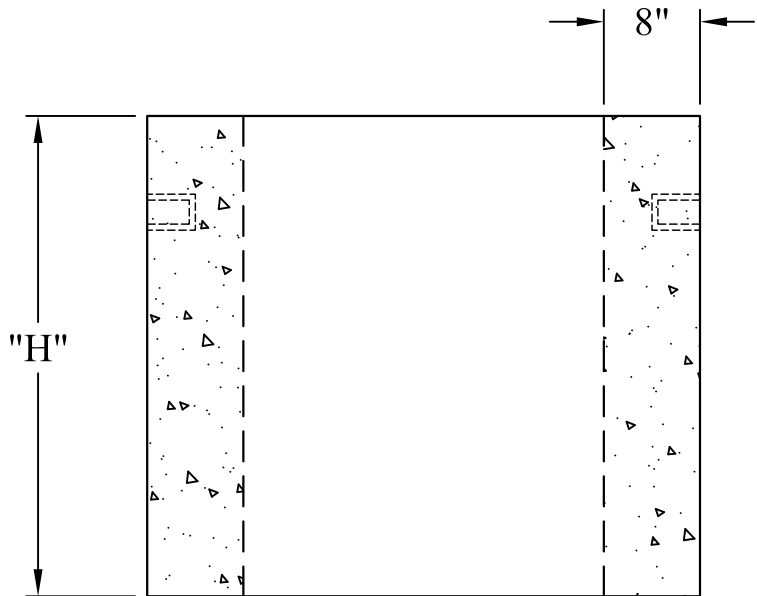

**General Notes**

- 1.) Concrete:  $f_c = 4,000$  psi @ 28 Days Minimum
- 2.) Design Loading: AASHTO-HS20-44

Phoenix  
Precast  
Products

**30" Diameter  
Drop Inlet Riser**

P/N: See Above