

General Notes

1. Concrete: $f_c = 4,000$ psi @ 28 Days Minimum
2. Reinforcement Steel Conforms to:
ASTM A615 Grade 60 Black Deformed Bars
3. Est Weight: 360 Lbs / Enclosure

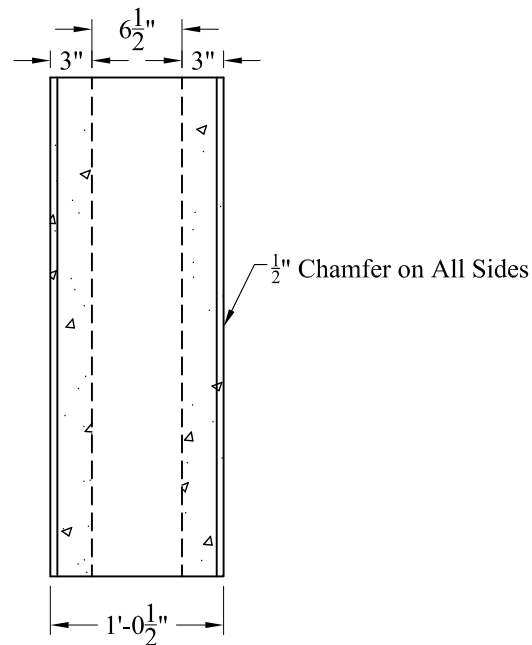

HILTI Two Part Epoxy at Joint (By Others)

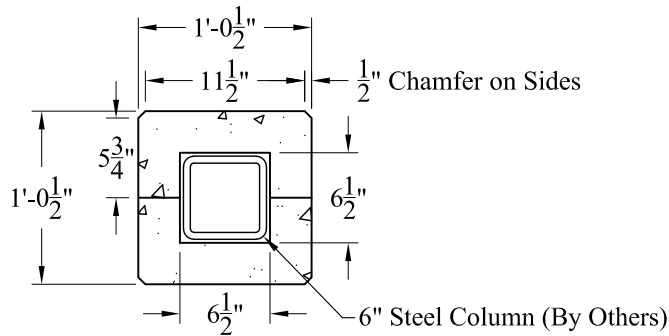
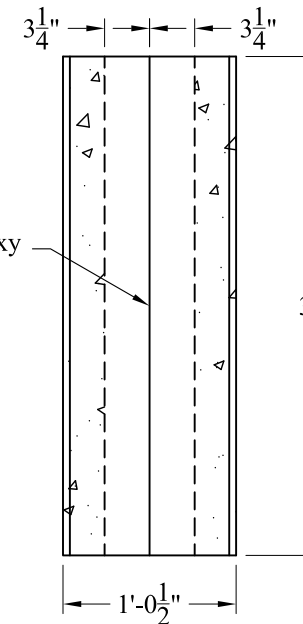

CP-3

Phoenix Precast Products

Phoenix Precast Products

Phoenix
Precast
Products

1'-0 1/2" x 1'-0 1/2" x 3'
Steel Column
Enclosure