

DETAIL B  
SCALE 1 : 10

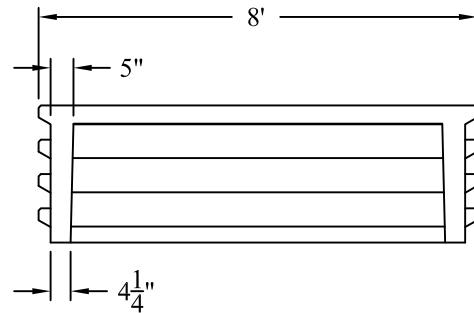
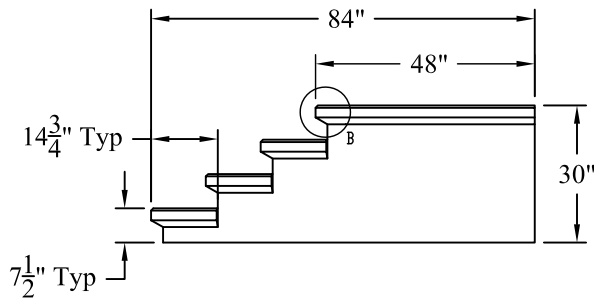
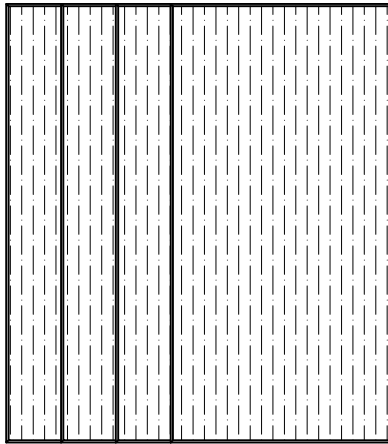

Est Weight 3,325 Lb

**General Notes**

- 1.) Concrete:  $f_c = 4,000$  PSI Minimum After 28 Days Minimum
- 2.) Broom Finish Supplied
- 3.) Blocks and Angles Attached To Poured Foundation By Phoenix Precast
- 4.) Optional Concrete Slab, Sono Tubes or Compacted Crushed Gravel By Others

Phoenix  
Precast  
Products

8Ft Wide  
4 Riser

P/N: PS-8WX4R

Concord, NH 03301