

Phoenix Precast Products

Phoenix Precast Products

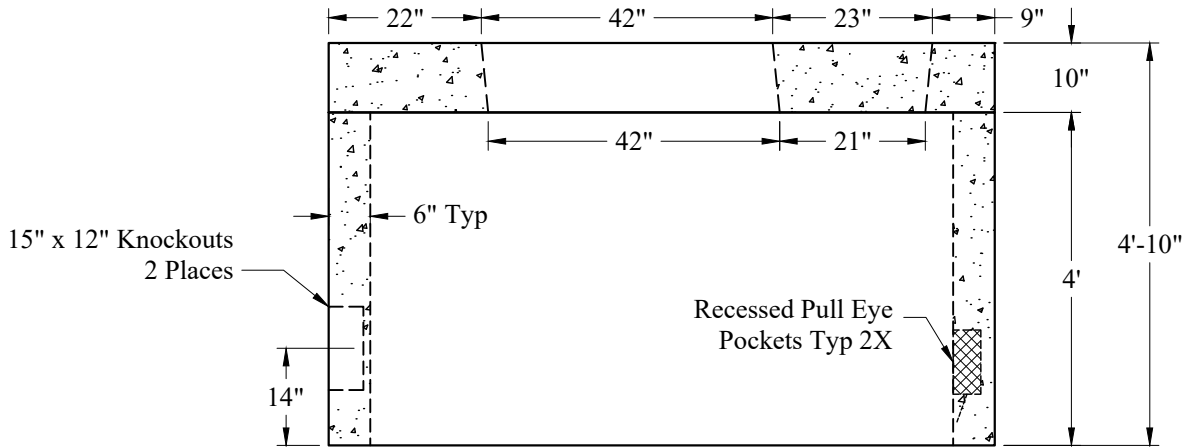

34.5 or 12.5 KV
75 to 500 KVA

Est Weights:
 Top Slab - 6,900 Lbs
 Base - 8,300 Lbs
 Total Weight: 15,200 Lbs

General Notes

1. Reinforcement Steel Conforms to:
ASTM A615 Grade 60
2. Concrete: $f_c = 5,000$ psi @ 28 Days Minimum
3. Butyl Rubber Joint Sealant Provided

Phoenix
Precast
Products

Central Vermont
Public Service Corp
2130 3-Phase Transformer
Pad And Pit

P/N: GMP-3PHTPP

Concord, NH 03301