

C:\Users\trouille\OneDrive - Sabbow & Co Inc\ray r Web Site 2024\Septic\_Tanks\2 Compartment HD Mid-Seam\1250-500\_HD\_2-Comp Mid-Seam Tank (New Form)\_Rev5.dwg

Standard Cover Configuration  
(3) 24" Dia Concrete Covers

Optional Cover Configuration  
(3) 24" Dia Plastic Risers  
Cast In, With Plastic Covers

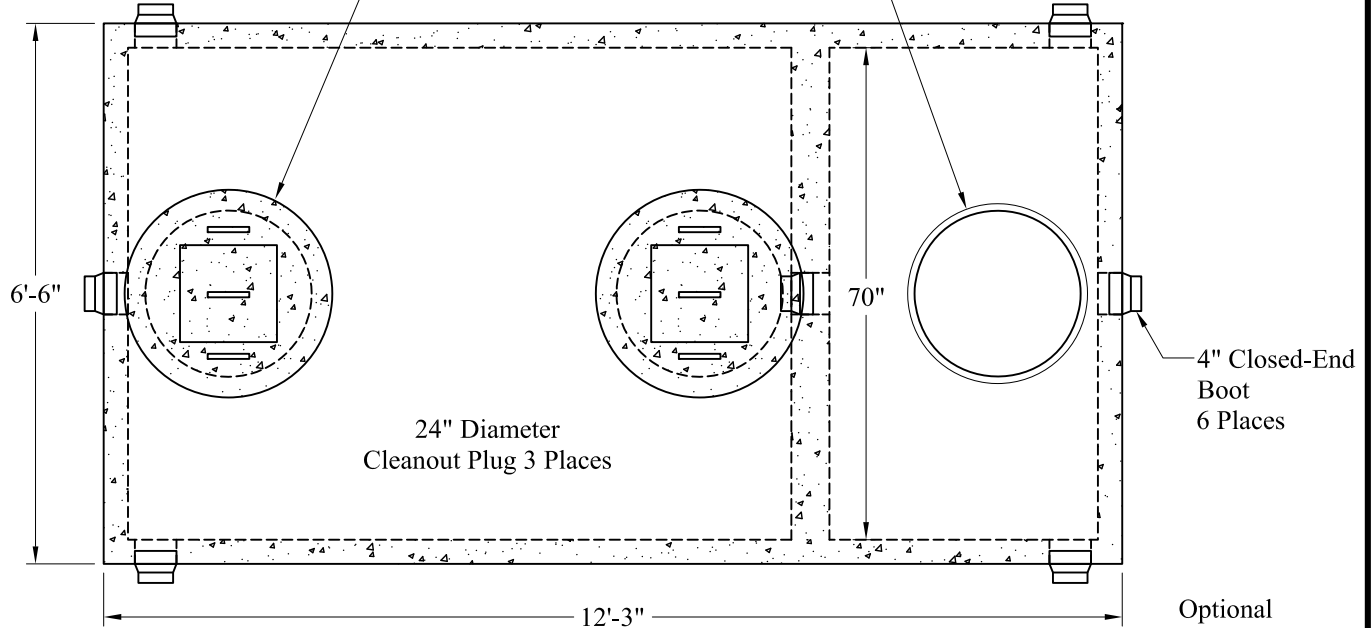

Optional Plastic Cover  
Domed Or Flat

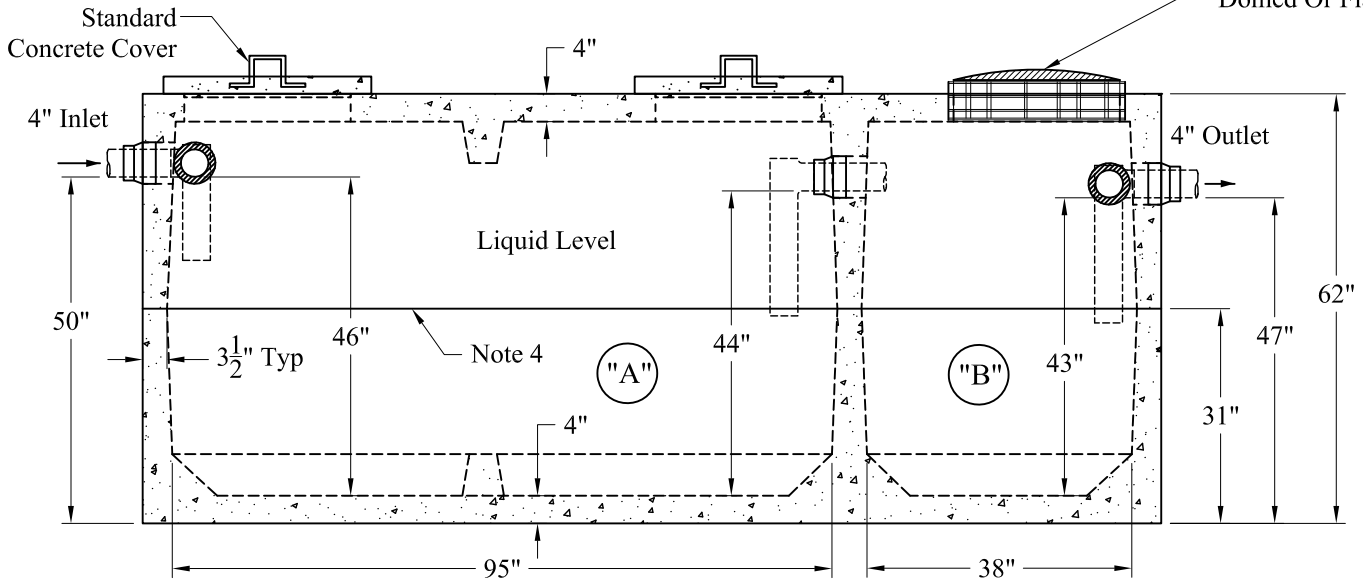

"A" Liquid Level = 345 Gals/VF (29 Gals/In)  
 "B" Liquid Level = 140 Gals/VF (12 Gals/In)  
 "A" = 1,276 Gals  
 "B" = 516 Gals  
 Total = 1,792 Gals

Est Weight:  
 Upper: 7,900 Lbs  
 Lower: 9,360 Lbs  
 Total: 17,260 Lbs

**General Notes**

1. Steel Reinforcement Conforms to Latest ASTM Specifications: ASTM-A615 Grade 60 Rebar
  2. Concrete:  $f_c = 4,000$  psi @ 28 Days Minimum
  3. Flexible Sleeves Used On All Pipe Openings
  4. Butyl Rubber Joint Sealant Provided
  5. Internal PVC Baffles Available
- Inlet:**  
 Shall Penetrate at Least 9" Below the Liquid Level But Not Deeper Than the Outlet Baffle.
- Outlet:**  
 Shall Extend Below the Surface of the Liquid Equal to 40% of the Liquid Depth (17").
6. HD Tanks: 3' - 6' Cover Max, Non-Traffic

Phoenix  
 Precast  
 Products

1250/500 Gallon HD  
 2 Compartment Tank

P/N: ST-1250/500HD  
 P/N: ST-1250/500PLSHD